

Hydraulic Hand Pallet Truck PT-BF type

- Full hydraulic system. Bullet connection between steering shaft and pump piston. It is convenient to replace the rear wheel.
- Easy to maneuver with 210 degrees turning radius.
- Grease fitting at all pivotal points to ensure trucks long life and easy control.
- Special lowering valve to control the rate of descent and over load by-pass valve to make the trucks durable.
- Number of pump strokes -10. Lift height per stroke: 12mm.
- Reliable oil leak-proof hydraulic system.
- Option: nylon wheel, polyurethane(PU) wheel, rubber wheel single fork roller or tandem roller.

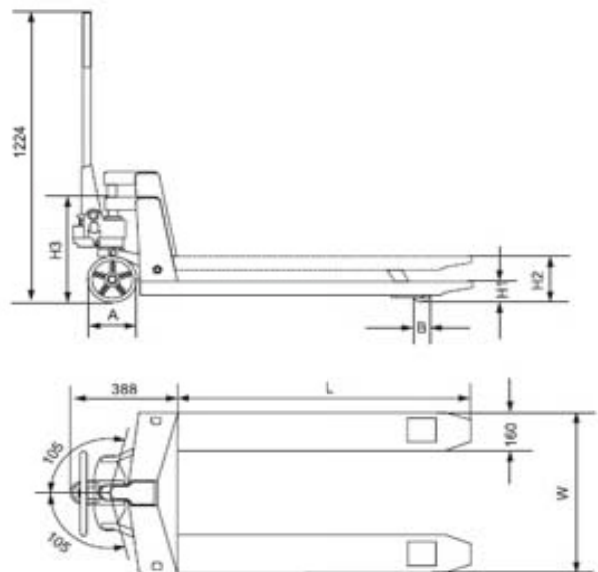
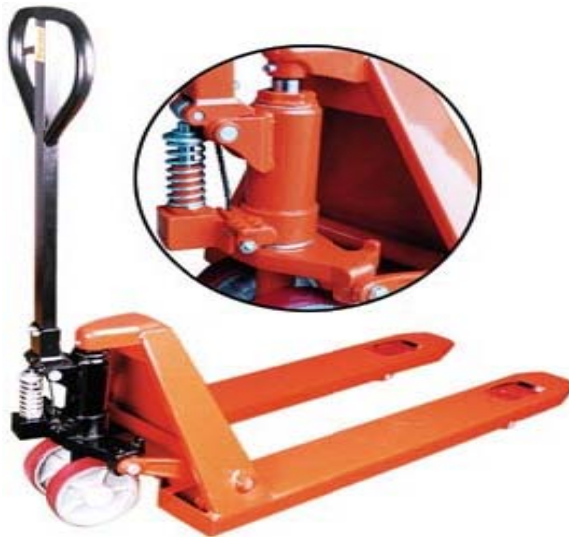

Model	PT-BF	
Capacity (kg)	2,500 kg / 3000 kg	
Total lift height H2(mm)	200	190
Lowered fork height H1(mm)	85	75
Height of handless H3(mm)	431.5	421.5
Fork Length L (mm)	1100/1,150/1220	1100/1,150/1220
Width over the forks W (mm)	520/550	685
Steering wheel A (mm)	Φ200	Φ180
Fork wheel B (mm)	Φ80	Φ74
Truck Weight (kg)	75/78 kg	80 kg

Hydraulic Hand Pallet Truck Economical Type

- Standard epoxy powder coat finish which is resistant to chips and normal corrosion.
- Exceptionally Strong but lift weight Steel construction, self weight is only 55kgs.
- With welded joints and reinforced fork tips for most durability in the toughest of applications.
- 3 position control lever Lifting-Natural-Lowering handle.
- Excellent turning angle of 190 degrees facilities.
- Number of pump stokes 12 times, lift height Per Stroke 11mm.
- Reliable oil leak-proof hydraulic systems.
- Option: nylon wheel, polyurethane(PU) wheel, single or tandem fork roller.

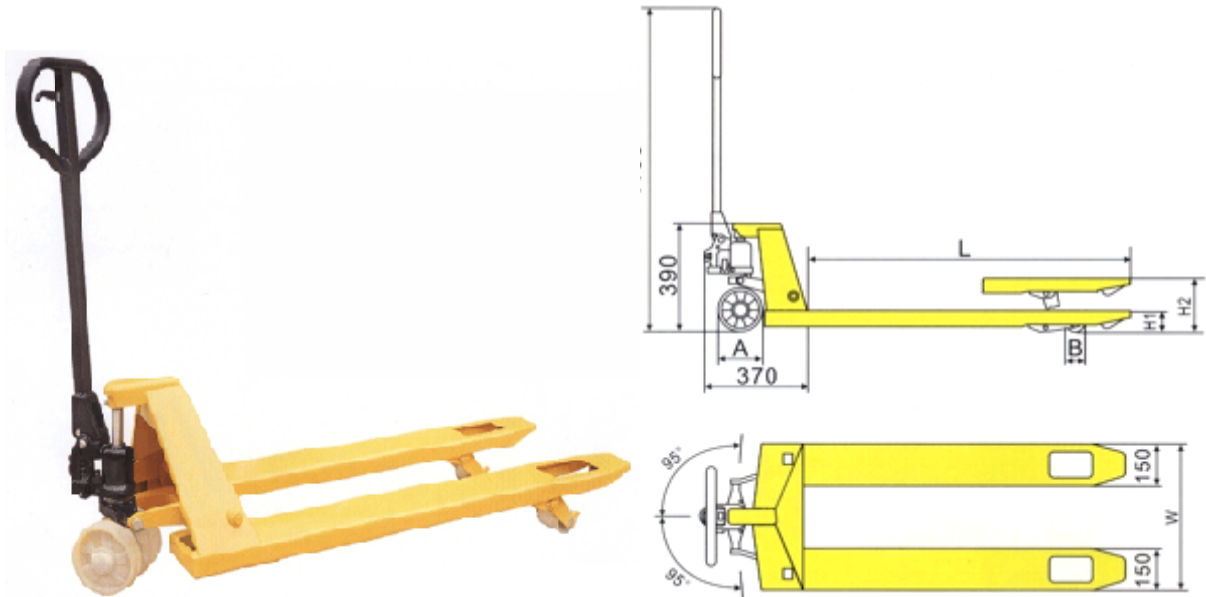

Model	PT-EC
Capacity (kg)	2000
Lowered fork height H1(mm)	75
Fork Length L (mm)	1100,1150,1220
Width over the forks W (mm)	520,550,685
Steering wheel A (mm)	Φ160
Fork wheel B (mm)	Φ70
Truck Weight (kg)	55~60

Hydraulic Hand Pallet Truck PT-DF type

- The oil pump body is made by way of welding the prefabricated parts together first, then machining the welded body.
- Rugged chrome piston and ram for smooth operation and prevents excessive wear on the pump & seal.
- Safety by-pass valve helps protect against overload.
- Excellent turning angle of 180 degrees facilities.
- Number of pump strokes -10. Lift height per stroke: 11mm.
- Option: nylon wheel, polyurethane wheel, rubber wheel, single fork roller or tandem fork roller

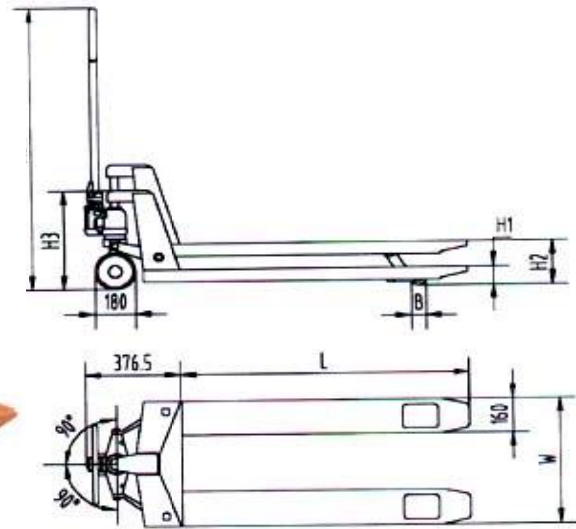

Model	PT-DF
Capacity (kg)	2,000-2,500
Total lift height H2(mm)	195/185//150
Lowered fork height H1(mm)	85/75/60
Height of handless H3(mm)	431.5/421.5/406.5
Fork Length L (mm)	900,980,1000,1100,1150,1220
Width over the forks W (mm)	550/685
Fork wheel B (mm)	Φ80/Φ74/Φ58
Truck Weight (kg)	75~102

Hydraulic Hand Pallet Truck with Scale

- Pallet truck with scale Mobile pallet truck with scale combined two major functions for pallet truck/scale, allows you to weigh cargo what you want, where you want and when you want.
- Reduces number of operators and saves time for maximum efficiency.
- Keypad and automatic tare functions.
- Large LCD display shows all measurement results in clearly readable numbers, even in dim lighting.
- The display can be read from different angles around the scale.
- Either internal or external power supply can be used.
- Available in pounds or kilograms.

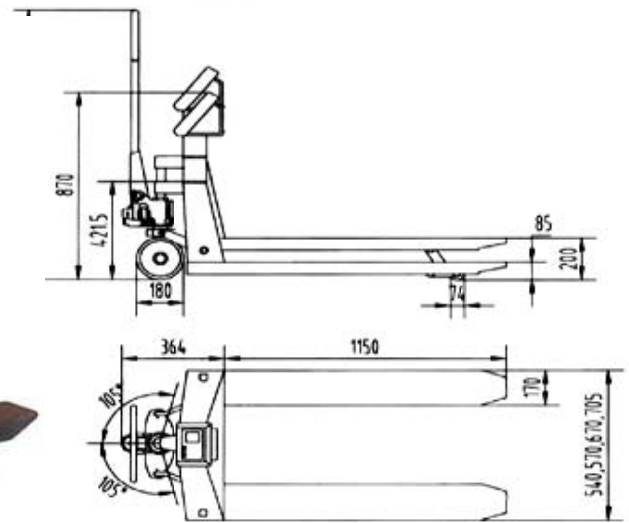

Model	PT-BFC
Capacity (kg)	2,000 kg
Total lift height (mm)	200
Lowered fork height (mm)	85
Fork Length L (mm)	1150
Width over the forks W (mm)	540/570/670/705
Steering wheel (mm)	Φ 180
Fork wheel (mm)	Φ 74
Truck Weight (kg)	100 ~ 110 kg

High Lift Pallet Truck

- Ideal design, pallet truck with the numerous possibilities makes this unit very suitable as pallet truck/scissor lift table.
- Telescopic jack composed of 3 piston rods creating light pumping force giving great rigidity.
- Support legs come into operation automatically. It prevents the unit from moving when the forks are raised to keep the safety of the operator.
- Truck automatically shows the descending speed when heavy goods loaded to help prevent cargo damage.
- 210 degree turning radius.
- Reduces physical effort and considerably improve the ergonomic conditions at work stations by raising the trucks to the desired height.
- 2 lateral stabilizers when raised ensure good stability.

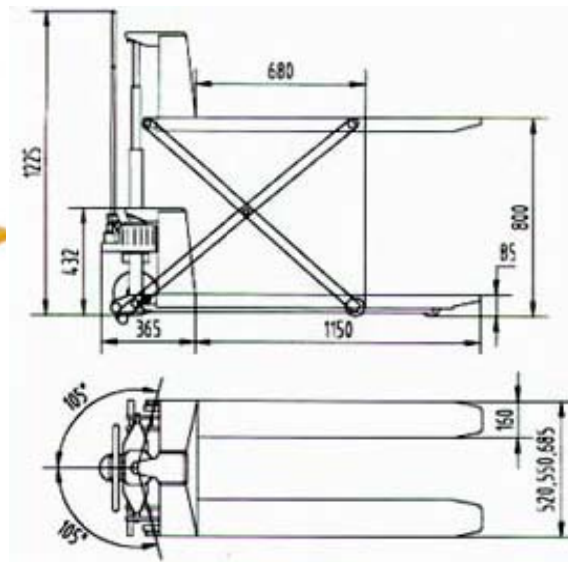

Model	PT-JF
Capacity (kg)	1,000
Total lift height (mm)	800
Lowered fork height (mm)	85
Height of handles (mm)	432
Fork length (mm)	1,150
Width over the forks (mm)	520,550,685
Steering wheel (mm)	Φ180x50
Fork wheel (mm)	Φ74x50
Truck weight (kg)	95 - 115

HANDLES OF PALLET TRUCK



2-stage fingertip lever which automatically stops lowering when released



3-stage fingertip (raise, neutral, lower) controlled loop handle



3-stage fingertip controlled rubber wrapped handle



2-stage fingertip rubber wrapped lever which automatically stops lowering when released



stainless steel 3-stage fingertip lever



3-stage tough-controlled lever



3-stage bar controlled handle

WHEELS OF HAND PALLET TRUCK



Smooth running nylon wheel



Extra silent polyurethane wheel
Polyurethane wrapped iron wheel
Polyurethane wrapped nylon wheel
Polyurethane wrapped aluminium wheel



Solid rubber wheel



Wheel for table truck
Nylon wheel, polyurethane wrapped iron wheel