

THL10000

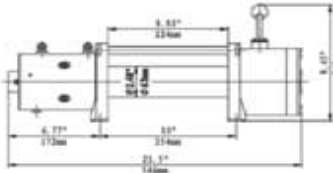

Rated line pull:	10000lbs(4540kgs) single line
Motor:	Series wound 2.7kw / 3.6hp
Gear train:	3 stage planetary
Gear ratio:	294:1
Clutch:	Sliding ring gear
Braking action:	Automatic in the drum
Fairlead:	4-way roller fairlead
Wire rope:	3/8"x89'(9.1mmx28m)
Drum size:	2.48"x8.82"(63mmx224mm)
Dimensions:	21.3"x6.3"x8.6"(562mmx180mmx128mm)
Bolt pattern:	10"x4.5"(254mmX114.3mm)
Net Weight:	84lbs(38kgs)

Line speed and motor current (first layer)

Line pull (Lbs/kgs)	Line speed (FPM/MPM)	Motor current (A)
0/0	27/7.5	70
2000/908	15.8/4.4	145
4000/1816	11.7/3.25	210
6000/2724	9.36/2.6	280
8000/3632	7.7/2.15	350
10000/4540	5.7/1.75	430

Line pull and cable capacity

Layer of cable	Rated line pull per layer (Lbs/kgs)	cable capacity per layer (Ft/m)
1	10000/4540	18/505
2	7700/3480	42/12
3	6500/2940	72/21
4	5700/2580	94/28

Fittings and Accessories (optional at extra cost)

Wireless Remote Control



Installation Stand



THL12000

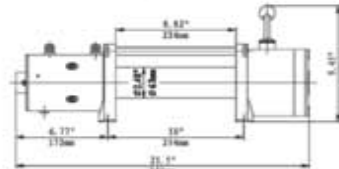

Rated line pull:	12000lbs(5443kgs) single line
Motor:	Series wound 4.3kw / 5.7hp (12V) 4.6kw / 6.1hp (24V)
Gear train:	3 stage planetary
Gear ratio:	265:1
Clutch:	Sliding ring gear
Braking action:	Automatic in the drum
Faairlead:	4-way roller fairlead
Wire rope:	3/8"x92'(10mmx28m)
Drum size:	2.48"x8.82"(63mmx224mm)
Dimensions:	21.5"x6.3"x9.45"(546mmx160mmx240mm)
Bolt pattern:	10"x4.5"(254mmX114.3mm)
Net Weight:	101.5lbs(46kgs)

Line speed and motor current (first layer)

Line pull (Lbs/kgs)	Line speed (FPM/MPM)		Motor current (A)	
	DC12V	DC24V	DC12V	DC24V
0/0	23.5/7.2	26.4/8.0	65	45
2000/908	12.6/3.8	15.1/4.6	126	80
4000/1816	10.3/3.1	13.1/4.0	175	105
6000/2724	8.7/2.65	10.9/3.3	230	135
8000/3632	7.2/2.2	9.7/2.95	280	160
10000/4540	6.3/1.9	8.3/2.5	355	190
12000/5443	5.0/1.5	7.2/2.2	400	230

Line pull and cable capacity

Layer of cable	Rated line pull per layer (Lbs/kgs)	cable capacity per layer (Ft/m)
1	12000/5443	16.4/5.0
2	9500/4309	37.7/11.5
3	7900/3583	64.0/19.5
4	6700/3039	92.0/28.0

Switch



Pulley Block



THL6000

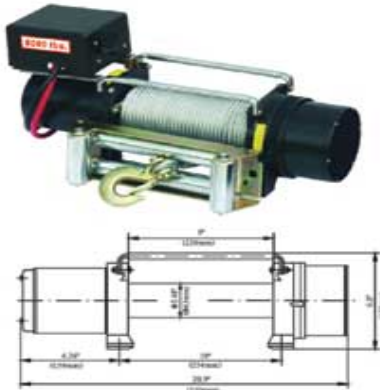

Rated line pull:	6000lbs(2722kgs)single line
Motor:	Permanent magnet DC 12 V: 1.3kw/1.8hp DC 24 V: 1.5kw/2.0hp
Gear ratio:	294:1(12V) 210:1(24V)
Wire rope:	9/32"x92"(7.2mmx28m)
Drum size:	2.48"x9"(63mmx228mm)
Dimensions:	20.9"x7.1"x6.8"(530mmx180mmx173mm)
Bolt pattern:	10"x4.5"(254mmX114.3mm)
Net Weight:	61.7lbs(28kgs)

THL7000

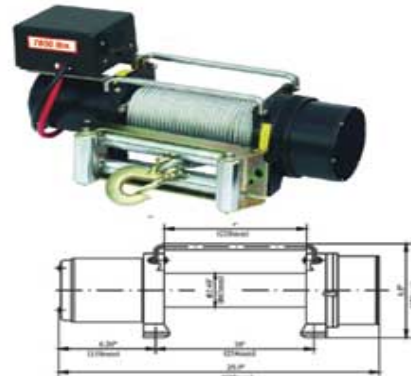

Rated line pull:	7000lbs(3185kgs)single line
Motor:	Permanent magnet DC 12 V: 1.7kw
Gear ratio:	210:1(12V)
Wire rope:	5/16"x94"(8.3mmx28m)
Drum size:	2.48"x9"(63mmx228mm)
Dimensions:	20.9"x7.1"x6.8"(530mmx180mmx173mm)
Bolt pattern:	10"x4.5"(254mmX114.3mm)
Net Weight:	75lbs(34kgs)

Line speed and motor current (first layer)

Line pull(lbs/kgs)	Line Speed(fpm/mpm)		Motor current(A)	
	DC12V	DC24V	DC12V	DC24V
0/0	12.0/3.7	18.0/5.5	45	25
2000/908	9.8/3.0	15.0/4.5	100	65
4000/1816	7.0/2.1	10.0/3.2	210	120
6000/2724	3.5/1.1	4.0/1.2	260	200

Line speed and motor current (first layer)

Line pull(lbs/kgs)	Line Speed(fpm/mpm)		Motor current(A)
	DC12V	DC12V	
0/0	13/3.8	30	
2000/908	9.8/3	100	
4000/1816	8/2.5	190	
6000/2724	6.3/1.9	270	
7000/3185	4.7/1.4	330	

Line pull and cable capacity

Layer of cable	Rated line pull per layer (lbs/kgs)	Cable capacity per layer (ft/m)
1	6000/2722	21.3/6.5
2	5000/2268	47.5/14.5
3	4200/1905	77/23.5
4	3700/1678	92.0/28.0

Line pull and cable capacity

Layer of cable	Rated line pull per layer (lbs/kgs)	Cable capacity per layer (ft/m)
1	7000/3185	21.3/6.5
2	5765/2594	47.5/14.5
3	4850/2182	77/23.5
4	4240/1908	92/28

Notice:

- 1)Do not use winch as a hoist, do not use for transportation of People
- 2)Don't operate and spool under full load over one minute continuously
- 3)While motor is over heating ,please stop for a while to cool down
- 4)Limited lifetime warranty

Fittings and Accessories (optional at extra cost)

Wireless Remote Control



Roller Fairlead



Installation Stand



TVK Series Electric Winches

The common feature of TVK500~8000 series of winches are that the motor is permanent magnet , and the power supply is 12v or 24v DC.

Notice:

- 1)Do not use winch as a hoist, do not use for transportation of People
- 2)Don't operate and spool under full load over one minute continuously
- 3)While motor is over heating ,please stop for a while to cool down
- 4)Limited lifetime warranty

TVK1000

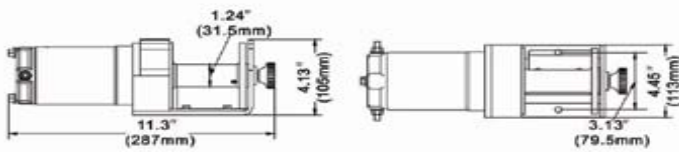

Features:

- 1)Free spooling clutch
- 2)Automatic braking action
- 3)Rated line pull with snatch block
- 4)SWR tension
- 5)DC 12V or DC24V power drive
- 6)A snatch block supplied as a standard accessory
- 7) High current working switch control directly
- 8)ATV Handlebar switch control

Rated line pull:	1000lbs(454kgs) single line
Motor:	permanent magnet DC 12V Input 1.3hp/1.0kW, Output0.8hp/0.6kW
Gear train:	1 stage planetary
Gear ratio:	153:1
Clutch:	Sliding gear
Braking action:	Automatic in the gear
Fairlead:	4-way roller fairlead
Wire rope:	5/32"×50'(4mm×15.2m)
Drum size:	1.24"×2.88"(31.5mm×73mm)
Dimensions:	11.3"×4.45"×4.13"(287mm×113mm×105mm)
Bolt pattern:	3.13"(79.5mm)
Net Weight:	16lbs(7.25kgs)

Line speed and motor current (first layer)

Line pull (Lbs/kg)	Line speed (FPM/mpm)	Motor current (Amps)
0/0	11.8/3.6	8
500/227	8.8/2.7	49
1000/454	6.2/1.9	85

Line pull and cable capacity

Layer of cable	Rated line pull per layer (lbs/kgs)	Cable capacity per layer (ft/m)
1	1000/454	6.5/2
2	816/370	14.1/4.3
3	689/313	22.3/6.8
4	597/271	31.1/9.5
5	526/239	41/12.5
6	470/213	50/15.2

Fittings and Accessories (optional at extra cost)

FL001



PB2000



THL2000

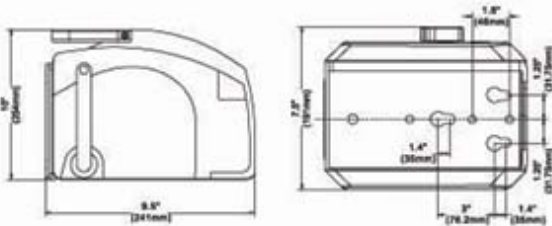

Capacity:	6000lbs. Rolling 5000lbs. Marine(Rolling Bunk) 2000lbs.Pulling Capacity
Max. Boat Size:	18 feet
Max. Boat Weight :	5000 lbs
Line Speed :	6ft/min with load
Cable Length:	30Ft
Power Supply:	12 Volts
Power Cord:	9.9in L.Negative Lead 9.9in L.Positive Lead
Remote Switch :	9.9in L.
Mounting Plate:	7-13/16 in x 4-3/8 in x1-1/4 in
Overall Dimensions:	7.8in x 8.7 in x 6.9in
Net Weight:	17.6lbs

Line speed and motor current (first layer)

Line pull(lbs/kgs)	Line Speed(fpm/mpm) DC12V	Motor current(A) DC12V
0/0	9.5/2.9	12
500/227	9.0/2.5	25
1000/454	7.5/2.3	40
2000/907	3.3/1.0	90

Line pull and cable capacity

Layer of cable	Rated line pull per layer (lbs/kgs)	Cable capacity per layer (ft/m)
1	2000/908	3.6/1.1
2	1618/735	9.5/2.9
3	1358/617	17/5.2
4	1170/531	26/7.9
5	1028/531	30/9.15

Notice:

- 1) Do not use winch as a hoist, do not use for transportation of people.
- 2) Do not operate and spool under full load over one minute continuously.
- 3) While motor is over heating, please stop for a while to cool down.
- 4) Limited lifetime warranty.

THL3000

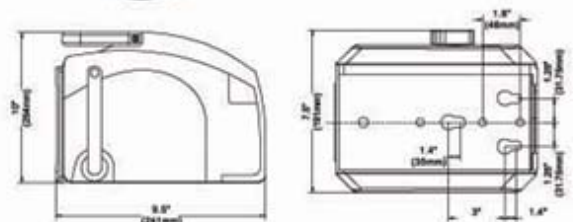

Capacity:	9000lbs. Rolling 7500lbs. Marine(Rolling Bunk) 3000lbs.Pulling Capacity
Max. Boat Size:	20 feet
Max. Boat Weight :	7500 lbs
Line Speed :	6ft/min with load
Cable Length:	30Ft
Power Supply:	12 Volts
Power Cord:	9.9in L.Negative Lead 9.9in L.Positive Lead
Remote Switch :	9.9in L.Positive Lead
Mounting Plate:	9.9in L. 8-3/4 in x 4-15/16 in x1-1/4 in
Overall Dimensions:	8in x 9 in x 7.5in
Net Weight:	24lbs

Line speed and motor current (first layer)

Line pull(lbs/kgs)	Line Speed(fpm/mpm) DC12V	Motor current(A)
0/0	9.5/2.9	10
1000/454	6.6/2.0	25
2000/908	4.3/1.3	60
3000/1362	2.3/0.7	150

Line pull and cable capacity

Layer of cable	Rated line pull per layer (lbs/kgs)	Cable capacity per layer (ft/m)
1	3000/1361	4.9/1.5
2	2269/1028	5.5/1.7
3	1773/804	6.3/1.9
4	1425/646	7.2/2.2
5	1170/530	7.9/2.4

THL4000

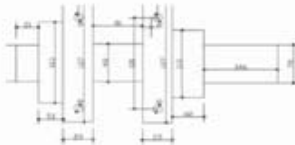

Rated line pull:	4000lbs(1816kgs) single line
Motor:	permanent magnet
	DC 12V: 1.1kw/1.45hp
Gear ratio:	173:1 (12V)
Cable(Dia x L):	7/32"x45.9"(5.6mmx14m)
Drum size:	1.89"x2.8"(48mmx71mm)
Dimensions:	14.9"x4.52"x4.72"(380mmx115mmx120mm)
Mounting Bolt Pattern:	3.13 " (79.5mm)
Net Weight:	18.1lbs(8.2kgs)

Line speed and motor current (first layer)

Line pull(lbs/kgs)	Line Speed(fpm/mpm)		Motor current(A)
	DC12V	DC12V	
0/0	10.5/3.2	16	
1000/454	9.2/2.8	30	
2000/908	7.5/2.35	36	
3000/1362	5.9/1.85	72	
4000/1816	3.3/1.0	123	

Line pull and cable capacity

Layer of cable	Rated line pull per layer (lbs/kgs)	Cable capacity per layer (ft/m)
1	4000/1816	6.36/1.9
2	3376/1532	13.2/4.14
3	2928/1329	21.9/6.68
4	2592/1176	31.2/9.6
5	2315/1051	29.6/12

Notice:

- 1)Do not use winch as a hoist, do not use for transportation of People
- 2)Don't operate and spool under full load over one minute continuously
- 3)While motor is over heating ,please stop for a while to cool down
- 4)Limited lifetime warranty

Fittings and Accessories (optional at extra cost)

Fairlead



Installation Plate



Switch



THL5000

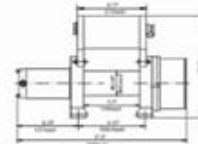

Rated line pull:	5000lbs(2268kgs) single line
Motor:	permanent magnet
	DC 12V: 1.3kw/1.8hp
	DC 24V: 1.5kw/2.0hp
Gear ratio:	294:1 (12V) 210:1 (24V)
Cable(Dia x L):	1/4"x79"(6mmx24m)
Drum size:	2.48"x5.5"(63mmx140mm)
Dimensions:	17.3"x7.1"x6.8"(440mmx180mmx173mm)
Mounting Bolt Pattern:	6.55X4.5 " (166mmX114mm)
Net Weight:	52.9lbs(24kgs)

Line speed and motor current (first layer)

Line pull(lbs/kgs)	Line Speed(fpm/mpm)		Motor current(A)	
	DC12V	DC24V	DC12V	DC24V
0/0	12/3.7	18/5.5	45	25
1000/454	10/3.2	16/4.8	90	55
3000/1362	7.5/2.3	11.5/3.5	150	110
5000/2268	5.0/1.5	5.3/1.6	230	180

Line pull and cable capacity

Layer of cable	Rated line pull per layer (lbs/kgs)	Cable capacity per layer (ft/m)
1	5000/2268	14.7/4.5
2	4200/1905	29.5/9.0
3	3700/1678	56.0/17.0
4	3200/1452	79.0/24.0